

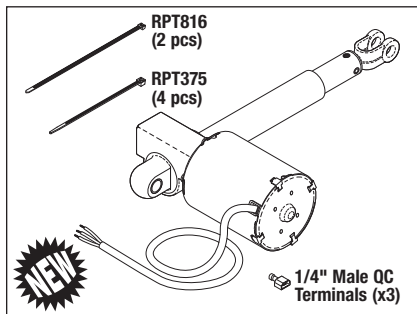

## New Parts to fit Midmark®•Ritter® 411 & 419 Exam Tables and Chairs!



**RPI Part #MIA164**  
**OEM Part #002-0215-00 & 002-0590-00**

### BACK & FOOT ACTUATOR

- 2.7A@115VAC
- Includes all parts as shown
- Fits:** Table Back and/or Foot Section
- Models:** See RPI website for Serial # breakdown of the models this part fits: 411 & 419

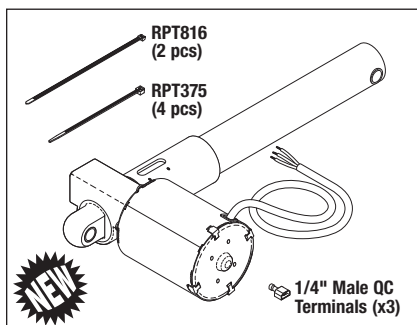

**RPI Part #MIA165**  
**OEM Part #002-0214-00 & 002-0562-00**

### BASE & TILT ACTUATOR

- 2.7A@115VAC
- Includes all parts as shown
- Fits:** Table Base and/or Tilt Section
- Models:** See RPI website for Serial # breakdown of the models this part fits: 411 & 419

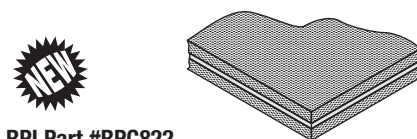

**RPI Part #RPC822**  
**OEM Part #054-0085-04, 054-0085-05, 054-0067-00, 054-0074-00 & 054-0145-00**

### SOUND DAMPING COMPOSITE

- Size: 12" x 12" x 1/2" thk.
- Acoustic foam with vinyl barrier core and adhesive backing
- Cut to size
- Fits:** Back, Foot and Base Chassis Assemblies
- Models:** All Serial #'s for: 411 & 419

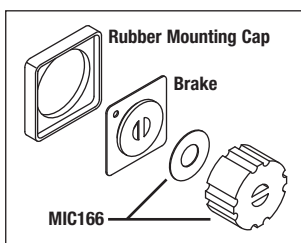

**RPI Part #MIK167**  
**OEM Part #016-0237-00 (Brake only)**

### BRAKE & COUPLER KIT

- Includes all parts as shown
- Also included in: Back & Foot Actuator (RPI Part #MIA164) and Base & Tilt Actuator (RPI Part #MIA165)
- Fits:** Only fits Back & Foot Actuator and Base & Tilt Actuator manufactured by Motion Systems
- Models:** See RPI website for Serial # breakdown of the models this part fits: 411 & 419

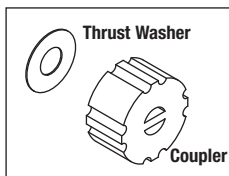

**RPI Part #MIC166**  
**OEM Part #016-0509-00**

### MOTOR COUPLER

- Size: 1.00" OD x .48" thk.
- Couples 5/16" dia. slotted shafts
- Includes: Coupler & Thrust Washer
- Also included in: Brake & Coupler Kit (RPI Part #MIK167)
- Fits:** Back & Foot Actuator and Base & Tilt Actuator
- Models:** See RPI website for Serial # breakdown of the models this part fits: 411 & 419

**RPI Part #RPT816**  
**OEM Part #015-0472-00**



### CABLE TIE (14" BLACK)

- 10 per package
- Size: 5/16" w x 14" lg.
- Fits:** Actuator



**RPI Part #RPT375**  
**OEM Part # (No OEM Part # Available)**

### CABLE TIE (12" BLACK)

- 25 per package
- Size: 3/16" w x 12" lg.
- Fits:** Actuator



**RPI Part #MIT177**  
**OEM Part #051-0412-00**

### SUPPORT BAR

- Use to support the weight of the table top when replacing the base actuator and the Gas Cylinder.
- Fits:** Left and Right Side Panels
- Models:** See RPI website for Serial # breakdown of the models this part fits: 411 & 419

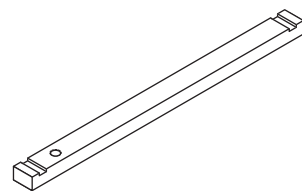

**RPI Part #MIT178**  
**OEM Part #051-0413-00**

### PRY BAR

- Use to compress the gas cylinder during removal and replacement.
- Fits:** Middle Member Assembly
- Models:** See RPI website for Serial # breakdown of the models this part fits: 411 & 419

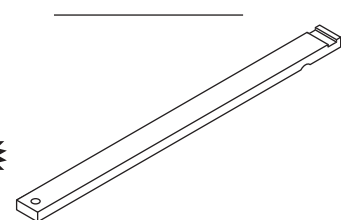

**RPI Part #MIC176**  
**OEM Part #002-0213-00 & 016-0236-01**  
 ("Double Gas Cylinder" design)

### GAS CYLINDER

- **Caution** - Use the Support Bar (RPI Part #MIT177) to support the Table Top and the Pry Bar (RPI Part #MIT178) to safely compress the Gas Cylinder during the removal and installation process.
- This Gas Cylinder replaces the "Double Gas Cylinder" design used in older versions of these tables.
- Fits:** Middle Member and Chassis Assembly
- Models:** See RPI website for Serial # breakdown of the models this part fits: 411 & 419

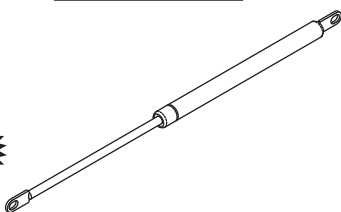

**replacement parts industries, inc.**

CALL (800) 221-9723 • FAX (818) 882-7028 • EMAIL [order@riparts.com](mailto:order@riparts.com) • WEBSITE [www.riparts.com](http://www.riparts.com)

The above parts are manufactured by Replacement Parts Industries, Inc. to fit Midmark•Ritter equipment. All product names used in this document are trademarks or registered trademarks of their respective holders. Show 04/13



**RPI Part #MIC168**  
**OEM Part #9A73001 (Velcro version) & 053-0412-00 (Clip On version)**

**HAND CONTROL**

- Includes options for both clip on and Velcro mounting. It's the RPI Advantage!
- Includes all parts as shown

**Fits:** Hand Control

**Model:** 411-001 thru -008 with Serial # prefixes AV, DJ & DW

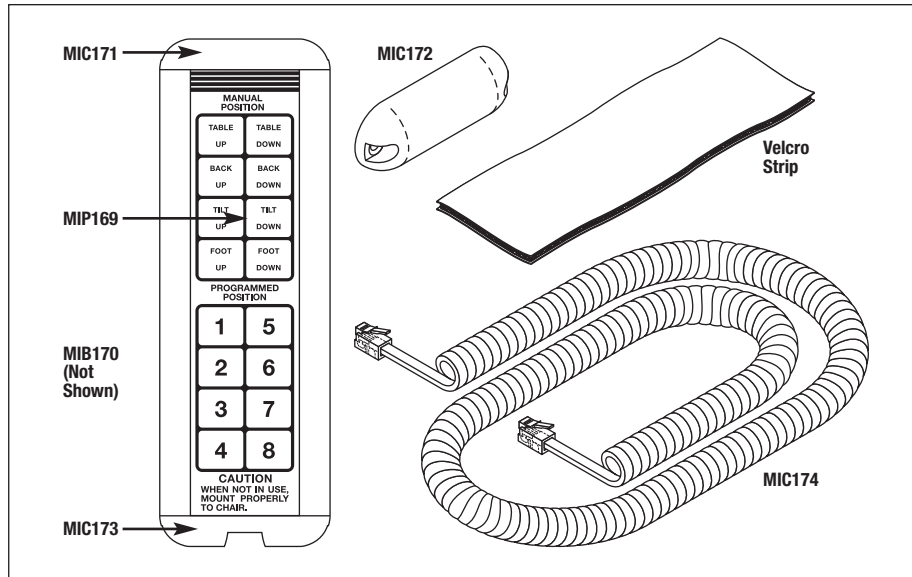

**RPI Part #MIP169**  
**OEM Part #015-0502-00**

**HAND CONTROL PANEL**

- Size: ~2.15" x 8.31"
- Includes: Metal Backing Plate
- Included in: Hand Control (RPI Part #MIC168)
- Also available: Hand Control PC Board (RPI Part #MIB170)

**Fits:** Hand Control

**Model:** 411-001 thru -008 with Serial # prefixes AV, DJ & DW

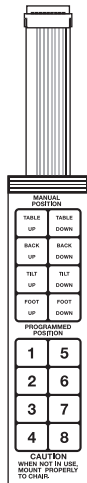

**RPI Part #MIB170**  
**OEM Part #002-0347-02**

**HAND CONTROL PC BOARD**

- Included in: Hand Control (RPI Part #MIC168)
- Also available: Hand Control Panel (RPI Part #MIP169) & Coil Cord (RPI Part #MIC174)

**Fits:** Hand Control

**Model:** 411-001 thru -008 with Serial # prefixes AV, DJ & DW

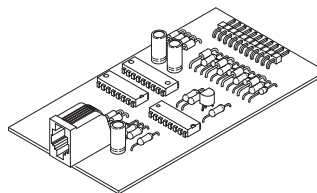

**RPI Part #MIC174**  
**OEM Part #015-0505-03**

**COIL CORD**

- Size: ~12 ft extended
- Color: Black
- Included in: Hand Control (RPI Part #MIC168)

**Fits:** Hand Control

**Models:** See RPI website for Serial # breakdown of the models this part fits: 405 & 411

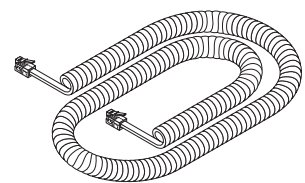

**RPI Part #MIC171**  
**OEM Part #053-0412-00**

**TOP END CAP (CLIP ON)**

- Includes: Mounting hardware
- Included in: Hand Control (RPI Part #MIC168)

**Fits:** Hand Control

**Models:** See RPI website for Serial # breakdown of the models this part fits: 405 & 411

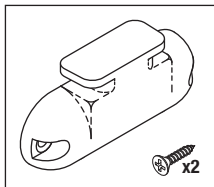

**RPI Part #MIC172**  
**OEM Part #053-0257-00**

**TOP END CAP (VELCRO)**

- Includes: Mounting hardware
- Included in: Hand Control (RPI Part #MIC168)

**Fits:** Hand Control

**Models:** See RPI website for Serial # breakdown of the models this part fits: 405 & 411

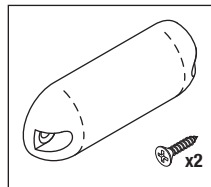

**RPI Part #MIC173**  
**OEM Part #053-0256-00**

**BOTTOM END CAP**

- Includes: Mounting hardware
- Included in: Hand Control (RPI Part #MIC168)

**Fits:** Hand Control

**Models:** See RPI website for Serial # breakdown of the models this part fits: 405 & 411

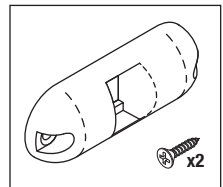

**Don't Forget, RPI offers a great selection parts to fit a wide variety of Midmark® • Ritter® Models!** See the At-a-Glance Cross Reference Table on our website [www.rpiparts.com](http://www.rpiparts.com) under Tech Help for the models and serial number breakdowns for all the RPI parts that fit Midmark® • Ritter® Exam Tables and Chairs, or search by equipment type and model to see the individual parts pages.

**RPI Part #MIP191**  
**OEM Part #015-0440-00**



**PROGRAM PANEL**

- Size: ~5.25" x 12.60"
- Includes: Metal mounting plate and mounting hardware
- Also available: Interface PC board (RPI Part #MIB192)

**Fits:** Side Console

**Model:** 411-001 thru -008 with Serial # prefixes AV, DJ & DW

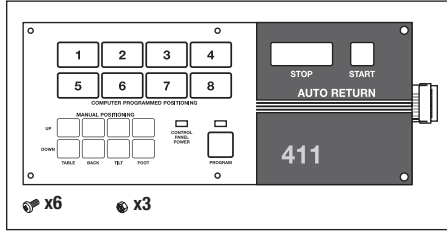

**RPI Part #MIS175**  
**OEM Part #015-0476-00**

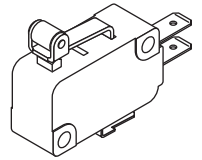

**LIMIT SWITCH**

- 0.1A@125VAC
- 3/16" Tabs

**Fits:** Column Assembly and Base Actuator

**Models:** See RPI website for Serial # breakdown of the models this part fits: 411 & 419

**RPI Part #MIB192**  
**OEM Part #015-0347-03**



**INTERFACE PC BOARD**

- Also available: Program Panel (RPI Part #MIP191)

**Fits:** Program Panel

**Model:** 411-001 thru -008 with Serial # prefixes AV, DJ & DW

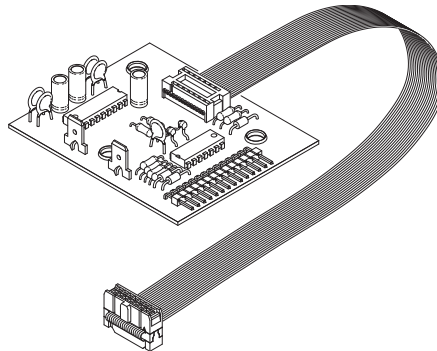

**RPI Part #MIS127**  
**OEM Part #015-0425-00**

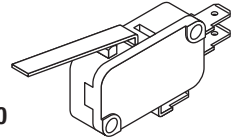

**LIMIT SWITCH**

- 10A@125/250VAC; SPDT
- .25" Tabs

**Fits:** Chassis

**Models:** See RPI website for Serial # breakdown of the models this part fits: Evolution 75, 111, 119, 311, 319, 411, 414 & 419

**RPI Part #MIC182**  
**OEM Part #015-0437-04**

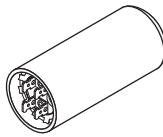

**CAPACITOR**

- Size: 1.44" dia. x 3.38" lg.
- 27-36 µF; 330VAC
- Dual .25" Tabs
- Also available: Capacitor Cap (RPI Part #MIC185) & Capacitor Mounting Bracket (RPI Part #MIB186)

**Fits:** Chassis

**Models:** See RPI website for Serial # breakdown of the models this part fits: 411 & 419

**RPI Part #MIC183**  
**OEM Part #015-0437-03**

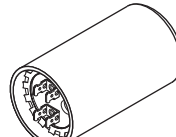

**CAPACITOR**

- Size: 1.81" dia. x 3.38" lg.
- 41-53 µF; 330VAC
- Dual .25" Tabs
- Also available: Capacitor Cap (RPI Part #MIC184) & Capacitor Mounting Bracket (RPI Part #MIB186)

**Fits:** Chassis

**Models:** See RPI website for Serial # breakdown of the models this part fits: 411, 413 & 419

**RPI Part #DEC610**  
**OEM Part #015-0437-00**

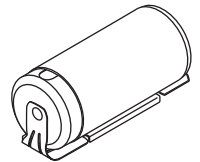

**CAPACITOR**

- Size: 1.81" OD x 3.38" lg. (Capacitor only)
- 54-64 µF; 330VAC
- Includes: Capacitor Mounting Bracket (RPI Part #MIB186) and Capacitor Cap (RPI Part #MIC184)

**Fits:** Base Motor/Base/Tilt Actuator

**Models:** See RPI website for Serial # breakdown of the models this part fits: Evolution 75, 411, 415 & 419

**RPI Part #MIC185**  
**OEM Part #015-0413-00**



**CAPACITOR CAP**

- Size: 1.44" dia.
- Fits:** Capacitor (1.44" dia.)
- Models:** All Serial #'s for: 105, 107, 305, 307, 405, 411, 414, 417, 418, 419 & 491

**RPI Part #MIC184**  
**OEM Part #015-0413-01**



**CAPACITOR CAP**

- Size: 1.81" dia.
  - Included in: Capacitor Kit (RPI Part #MIC020) & Capacitor (RPI Part #DEC610)
- Fits:** Capacitor (1.81" dia.)
- Models:** All Serial #'s for: Evolution 75, 105, 106, 107, 111, 112, 113, 114, 115, 116, 117, 119, 305, 306, 307, 311, 317, 318, 319, 411, 413, 415 & 419

**RPI Part #MIB186**  
**OEM Part #015-0412-00**

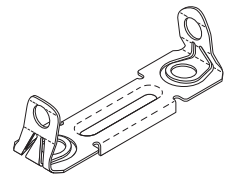

**CAPACITOR MOUNTING BRACKET**

- Included in: Capacitor Kit (RPI Part #MIC020) & Capacitor (RPI Part #DEC610)
- Fits:** Chassis
- Models:** All Serial #'s for: Evolution 75, 105, 106, 107, 111, 112, 113, 114, 115, 116, 117, 119, 305, 306, 307, 311, 317, 318, 319, 405, 411, 413, 414, 415, 417, 418, 419 & 491



ADDRESS SERVICES REQUESTED

## New Parts to fit Midmark® • Ritter® 222 & 622 Exam Tables and Chairs!



**RPI Part #MIC187**  
**OEM Part #016-1024-00**

### LOCKING GAS CYLINDER

- Also available: Actuator Cap Kit (RPI Part #MIK189) & Plunger (RPI Part #MIP188)
- Extension Force = 475 N (107 LBF)

**Fits:** Back Assembly

**Models:** See RPI website for Serial # breakdown of the models this part fits: 222 & 622

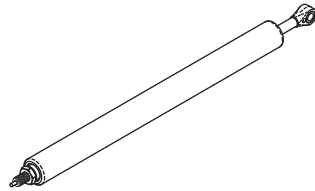

**RPI Part #MIC088**  
**OEM Part #016-0240-00**

### LOCKING GAS CYLINDER

- Also available: Actuator Cap Kit (RPI Part #MIK189) & Plunger (RPI Part #MIP188)
- Extension Force = 400 N (90 LBF)

**Fits:** Back Assembly

**Models:** See RPI website for Serial # breakdown of the models this part fits: 222, 404 & 622

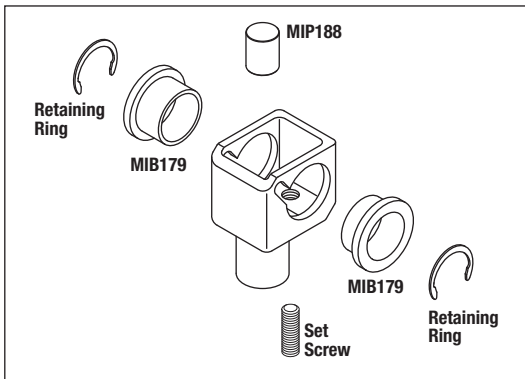
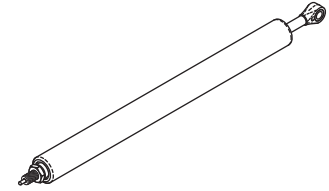

**RPI Part #MIK189**  
**OEM Part #020-0052-00, 020-0052-03 (Actuator Cap only), 040-0250-26 (Set Screw only) & 042-0066-00 (Retaining Ring only)**

### ACTUATOR CAP KIT

- Includes all parts as shown
- Also available: Locking Gas Cylinder (RPI Part #'s MIC088 & MIC187)

**Fits:** Back Assembly

**Models:** See RPI website for Serial # breakdown of the models this part fits: 222, 404 & 622



**RPI Part #MIP188**  
**OEM Part #053-0247-00**

### PLUNGER

- Solid plastic construction for added durability.
- Included in: Actuator Cap Kit (RPI Part #MIK189)
- Also available: Locking Gas Cylinder (RPI Part #'s MIC088 & MIC187)

**Fits:** Actuator Cap

**Models:** See RPI website for Serial # breakdown of the models this part fits: 222, 404 & 622



**RPI Part #MIB179**  
**OEM Part #053-0246-00**

### PIVOT BUSHING

- 2 per package
- Included in: Actuator Cap Kit (RPI Part #MIK189)
- Also available: Locking Gas Cylinder (RPI Part #'s MIC088 & MIC187)

**Fits:** Actuator Cap

**Models:** See RPI website for Serial # breakdown of the models this part fits: 222, 404 & 622

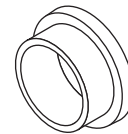

**Don't Forget, RPI offers a great selection parts to fit a wide variety of Midmark® • Ritter® Models!** See the At-a-Glance Cross Reference Table on our website [www.rpiparts.com](http://www.rpiparts.com) under Tech Help for the models and serial number breakdowns for all the RPI parts that fit Midmark® • Ritter® Exam Tables and Chairs, or search by equipment type and model to see the individual parts pages.