

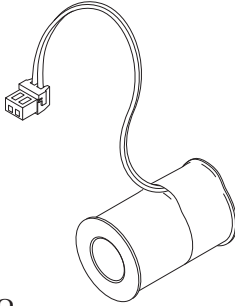

# More New Parts to Fit PELTON & CRANE SPIRIT® DELIVERY UNITS



**RPI Part #PCC777**  
**OEM Part #**  
*(No OEM Part # Available)*

**WATER SOLENOID COIL**

- Coil Rating: 12VDC; ~44Ω
- Coil: .990" L x .620" W with .363" dia. through hole
- Wire #: 24 AWG; 5-3/8" lg with JST connector

**Fits:** Drive Solenoid & Plug Assembly

**Models:** Spirit, Spirit II, Spirit IIE & Spirit EC

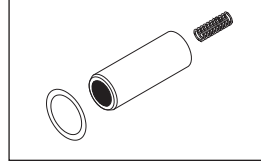

**RPI Part #PCK754**  
**OEM Part #** *(No OEM Part # Available)*

**WATER SOLENOID REPAIR KIT**

- Includes plunger body with rubber insert, spring, and O-ring (RPI Part #RPO302)

**Fits:** Drive Solenoid & Plug Assembly  
(OEM Part #15 35 371)

**Models:** Spirit, Spirit II, Spirit IIE & Spirit EC



**RPI Part #PCC790**  
**OEM Part #33 02 762**

**HANDPIECE BLOCK CONNECTOR**

- 8 per package
- .365" dia. x .365" lg.; Material: Brass
- Includes (2) O-rings (RPI Part #RPO305) per connector (installed)

**Fits:** High & low speed handpiece blocks

**Models:** Spirit, Spirit II, Spirit IIE & Spirit EC

**RPI Part #PCS788**  
**OEM Part #021833**

**AIR VALVE STEM**

- 2.56" lg.; Stainless steel
- Includes O-ring (RPI Part #RPO312)
- Uses 3/32" hex key

**Fits:** High & low speed handpiece blocks

**Models:** Spirit, Spirit II, Spirit IIE & Spirit EC

**RPI Part #PCS789**  
**OEM Part #020177**

**WATER VALVE STEM**

- 3.12" lg.; Stainless steel
- Includes O-ring (RPI Part #RPO312)

**Fits:** High & low speed handpiece blocks

**Models:** Spirit, Spirit II, Spirit IIE & Spirit EC

**RPI Part #PCS791**  
**OEM Part #94 47 897**

**WATER VALVE STEM**

- 5.60" lg.; Stainless Steel
- Includes O-ring (RPI Part #RPO312)
- Uses 1/8" hex key

**Fits:** Scaler or electronic motor assembly

**Models:** Spirit IIE & EC

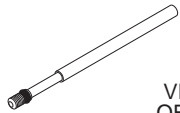

VIEW OF TIP

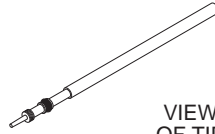

VIEW OF TIP

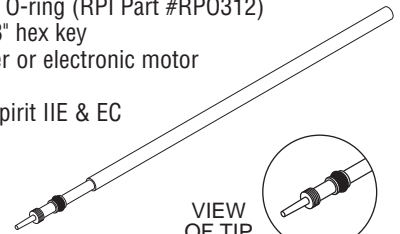
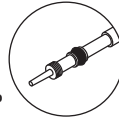

VIEW OF TIP

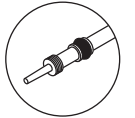

**Listing of NEW parts to fit Pelton & Crane Spirit<sup>®</sup> Delivery Units introduced since April, 2007.**

**For more parts to fit the Spirit, see the RPI catalog or website.**

RPI PART #	OEM PART#	DESCRIPTION	SPIRIT	SPIRIT II	SPIRIT IIE	SPIRIT AC	SPIRIT EC
PCC772	94 33 541	FEMALE QUICK CONNECT (1/16")				•	
PCC773	94 33 533	MALE QUICK CONNECT (1/16")				•	
PCC777	<i>(No OEM Part # Available)</i>	WATER SOLENOID COIL	•	•	•		•
PCC790	33 02 762	HANDPIECE BLOCK CONNECTOR	•	•	•		•
PCG760	30 04 484	PRESSURE GAUGE				•	
PCK754	<i>(No OEM Part # Available)</i>	WATER SOLENOID REPAIR KIT	•	•	•		•
PCK775	51 51 779	ANTI-SIPHON VALVE KIT				1	
PCL768	30 03 402	AIR INDICATOR (GREEN)				•	
PCS788	021833	AIR VALVE STEM	•	•	•		•
PCS789	020177	WATER VALVE STEM	•	•	•		•
PCS791	94 47 897	WATER VALVE STEM			•		•
PCV765	<i>(No OEM Part # Available)</i>	VALVE STEM				•	
PCV766	15 33 764	VALVE TOGGLE SWITCH				•	
PCV767	18 98 902	CHECK VALVE				•	
PCV787	33 07 431	AUTOHOLDER VALVE				•	
RPO617	70 32 741	O-RING				•	

1 = Fits Spirit AC Serial #4839 and below.



**replacement parts industries, inc.**

CALL (800) 221-9723 • FAX (818) 882-7028 • EMAIL [order@rpiparts.com](mailto:order@rpiparts.com) • WEBSITE [www.rpiparts.com](http://www.rpiparts.com)

The above parts are manufactured by Replacement Parts Industries, Inc. to fit Pelton & Crane equipment. All product names used in this document are trademarks or registered trademarks of their respective holders. WEB FLYER 05/07