

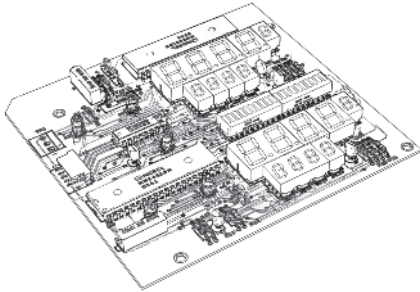

## More New Parts to fit Giraffe® Infant Incubators and OmniBed®!



**RPI Part #OMB056**  
**OEM Part #6600-0215-850**  
**LED PC BOARD**  
 Fits: Display Module  
 Models: Giraffe Incubator & Giraffe OmniBed

Includes all parts as shown

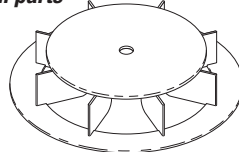

**RPI Part #OMK046**  
**OEM Part #6600-1738-500 (Fan Blade only) & 6600-1440-500 (Hub only)**  
**FAN AND HUB KIT**  
 • Includes: Fan Hub (RPI Part #OMH044), Fan Seal (RPI Part #OMS045), and Fan Blade  
 Fits: Fan Motor Shaft  
 Models: Giraffe Incubator & Giraffe OmniBed

**RPI Part #OMH044**  
**OEM Part #6600-1440-500**



**FAN HUB**  
 • Material: Gray rubber  
 • Included in: Fan and Hub Kit (RPI Part #OMK046)  
 Fits: Fan Blade  
 Models: Giraffe Incubator & Giraffe OmniBed

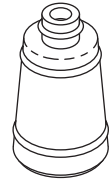

**RPI Part #OMS045**  
**OEM Part #6600-1557-500**



**FAN SEAL**  
 • Material: Black Silicone Rubber  
 • Included in: Fan and Hub Kit (RPI Part #OMK046)  
 Fits: Fan Motor Shaft and Heatsink  
 Models: Giraffe Incubator & Giraffe OmniBed



Includes all parts as shown

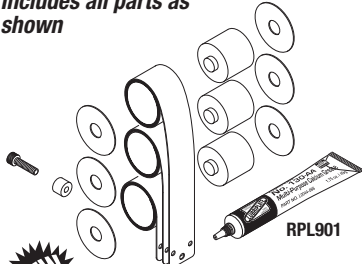

**RPI Part #OMK058**  
**OEM Part #6600-1708-500 (Delrin Washer only), 6600-1464-500 (Upper Buoyancy Spring only), 6600-1465-500 (Lower Buoyancy Spring only), 6600-1725-500 (Left Buoyancy Spring only), 6600-1103-400 (Spacer only), 6600-1151-400 (Screw only) & 6600-1317-500 (Spring Spool only)**

**BUOYANCY SPRING KIT (LEFT)**

• Includes: Upper Buoyancy Spring, Lower Buoyancy Spring, Left Buoyancy Spring, Spacer, Screw (M5 x 20), (6) Delrin Washers, (3) Spring Spools and Lubriplate (130AA) (RPI Part #RPL901)  
 • Also available: Arrow Clip (RPI Part #RPC902)

**Fits:** Left Upright  
**Model:** Giraffe OmniBed

Includes all parts as shown

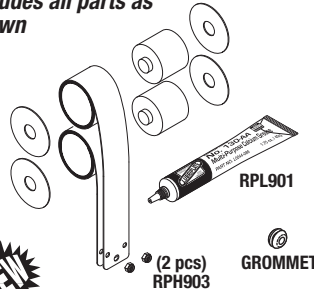

**RPI Part #OMK057**  
**OEM Part #6600-1708-500 (Delrin Washer only), 6600-1464-500 (Upper Buoyancy Spring only), 6600-1465-500 (Lower Buoyancy Spring only), 6600-1317-500 (Spring Spool only), 6600-1187-400 (Grommet only) & 6600-0714-401 (Lock Nut only)**

**BUOYANCY SPRING KIT (RIGHT)**

• Includes: Upper Buoyancy Spring, Lower Buoyancy Spring, (4) Delrin Washers, (2) Spring Spools, (2) Lock Nuts (M3) (RPI Part #RPH903), Lubriplate (130AA) (RPI Part #RPL901), and Grommet  
 • Also available: Belt Block Kit (RPI Part #OMK060), Lift Belt (RPI Part #OMB030) and Arrow Clip (RPI Part #RPC902)

**Fits:** Right Upright (Motor Side)  
**Model:** Giraffe OmniBed



**RPI Part #RPL901**  
**OEM Part #0616-0203-300 (10 oz. Tube)**

**LUBRIPLATE® (130AA)**  
 • 1.75 oz. resealable tube  
 • MSDS available on RPI website  
 • Included in: Buoyancy Spring Kit (Right) (RPI Part #OMK057) and Buoyancy Spring Kit (Left) (RPI Part #OMK058)  
 Models: Giraffe Incubator & Giraffe OmniBed

**RPI Part #RPH903**  
**OEM Part #6600-0714-401**



**LOCKNUT (M3 - Nylok®)**  
 • 10 per package  
 • Size: M3  
 • Material: Stainless steel with nylon insert  
 • Included in: Buoyancy Spring Kit (Right) (RPI Part #OMK057)  
 Models: Giraffe Incubator & Giraffe OmniBed



**replacement parts industries, inc.**

CALL (800) 221-9723 • FAX (818) 882-7028 • EMAIL [order@rpiparts.com](mailto:order@rpiparts.com) • WEBSITE [www.rpiparts.com](http://www.rpiparts.com)

The above parts are manufactured by Replacement Parts Industries, Inc. to fit OHMEDA®GE equipment. All product names used in this document are trademarks or registered trademarks of their respective holders. SHOW 09/15

# Infant Incubators

Models: Giraffe® Incubator & Giraffe® OmniBed®

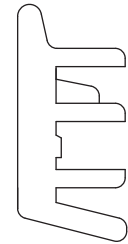
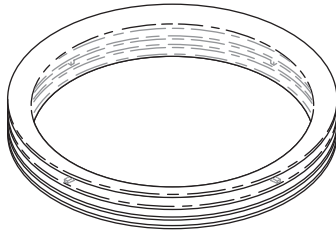

OMS052  
CROSS SECTION  
SHOWN ACTUAL SIZE

**RPI Part #OMS052**  
**OEM Part #6600-1249-500**

## PORTHOLE SEAL

- Material: Translucent thermoplastic rubber
- Fits:** Hood Assembly
- Models:** Giraffe Incubator & Giraffe OmniBed

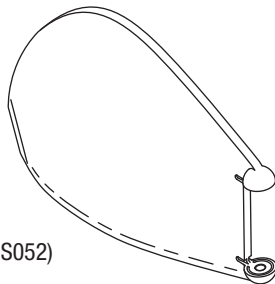

**RPI Part #OMD051**  
**OEM Part #6600-1238-500**

## PORTHOLE DOOR

- Material: Clear plastic
- Also available: Porthole Seal (RPI Part #OMS052) and Porthole Hinge Kit (RPI Part #OMK029)
- Fits:** Hood Assembly
- Models:** Giraffe Incubator & Giraffe OmniBed

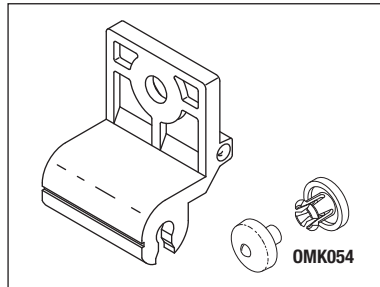

**RPI Part #OMK053**  
**OEM Part #6600-1149-500** (Side Wall Hinge only),  
**6600-1436-500** (Wall Hinge Snap only) &  
**6600-1429-500** (Wall Hinge Post only)

## SIDE WALL HINGE KIT

- Includes: Side Wall Hinge, and Wall Hinge Snap & Post Kit (RPI Part #OMK054)
- Also available: Side Wall Latch Kit (RPI Part #OMK028)
- Fits:** Hood Assembly
- Models:** Giraffe Incubator & Giraffe OmniBed

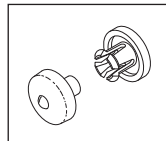

**RPI Part #OMK054**  
**OEM Part #6600-1436-500** (Wall Hinge Snap only)  
& **6600-1429-500** (Wall Hinge Post only)

## WALL HINGE SNAP & POST KIT

- Included in: Side Wall Hinge Kit (RPI Part #OMK053)
- Fits:** Side Wall Hinge and Hood Assembly
- Models:** Giraffe Incubator & Giraffe OmniBed



**RPI Part #OMK050**  
**OEM Part #6600-1099-400**  
(Isolator Only), **6600-0712-403**  
(Flat Washer Only), **6600-0713-403**  
(Lock Washer Only) & **6600-0707-407**  
(Screw Only)

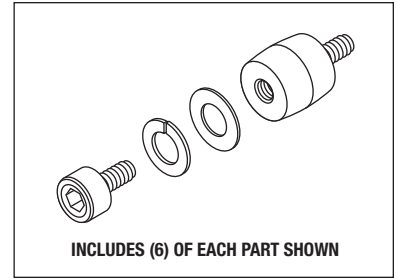

INCLUDES (6) OF EACH PART SHOWN

## LIFT MOTOR ISOLATOR KIT

- 6 per package
- Size: .39" (10mm) Dia x .39" (10mm) Ht.
- Includes: (6) Lift Motor Isolators, and mounting hardware
- Fits:** Right Hand Upright
- Model:** Giraffe OmniBed

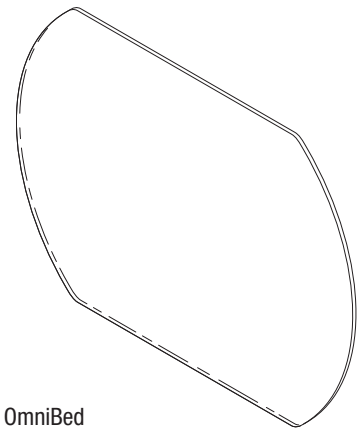

**RPI Part #OMP059**  
**OEM Part #6600-1365-500**

## PLATE

- Size: 25.75" x 19.25" x .13" Thk.
- Material: Clear plastic
- Fits:** Bed Assembly
- Models:** Giraffe Incubator & Giraffe OmniBed



**RPI Part #OMC049**  
**OEM Part #6600-1176-400**

## GEARBOX COUPLER

- Includes: Cross-Clamp Hub, and Urethane Gear Grip Sleeve
- Fits:** Lift Motor
- Model:** Giraffe OmniBed

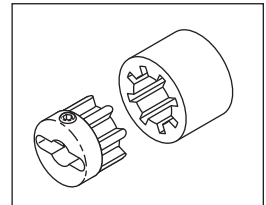

**RPI Part #OMF043**  
**OEM Part #6600-1433-500**

## FAN BLADE

- Size: 2.25" dia.
- Includes: Spring clip
- Fits:** Fan motor
- Models:** Giraffe Incubator & Giraffe OmniBed

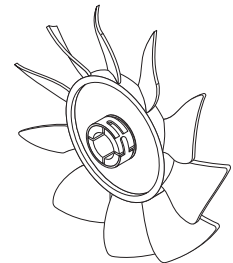

**RPI Part #OMM047**  
**OEM Part #6600-1000-400**

## MOTOR MOUNT

- 4 per package
- Size: .59" dia. x .63" Ht.
- Fits:** Fan Motor Bracket
- Models:** Giraffe Incubator & Giraffe OmniBed





**RPI Part #RPH933**  
**OEM Part #6600-1151-400**



**SCREW (M3 x 10mm S/S Flat Hd. Allen)**

- 25 per package
- Material: Stainless steel

**Fits:** Belt Block

**Models:** Giraffe Incubator & Giraffe OmniBed



**RPI Part #RPC902**  
**OEM Part #6600-1056-400**



**ARROW CLIP**

- 6 per package
- Hole dia.: .250"; Material: Nylon
- Size: .50" dia. head x .57" lg.

**Fits:** Soffit

**Model:** Giraffe OmniBed



**RPI Part #RPA032**  
**OEM Part # (No OEM Part # Available)**

**THREADLOCKER 242**

- 5 per package; .02 fl. oz. (.5ml) per tube
- Prevents rust and corrosion
- Removable adhesive by Loctite®
- MSDS available on RPI website

**Fits:** Lift Belt

**Model:** Giraffe OmniBed

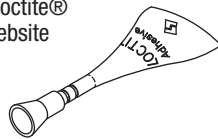

**RPI Part #OMS031**  
**OEM Part #6600-1071-400**

**BELT TENSIONER SPRING**

- Size: .54" OD x .75" lg. x .06" wire
- Material: Stainless steel
- Included in: Lift Belt (RPI Part #OMB030)

**Fits:** Lift Belt/Lift Rail Channel

**Model:** Giraffe OmniBed



**RPI Part #OMK060**  
**OEM Part #6600-1357-500 (Belt Adjuster, Bottom only), 6600-1358-500 (Block Adjuster, Top only), 6600-1151-400 (Screw, M3 x 10 only) & 6600-1187-400 (Grommet only)**

**BELT BLOCK KIT**

- Material: Brass
- Includes: Belt Block Set, (2 pcs) Screw (M3 x 10mm) (RPI Part #RPH933), Grommet, and (1 Tube) Threadlocker 242 (RPI Part #RPA032)
- Also available: Lift Belt (RPI Part #OMB030)

**Fits:** Lift Belt

**Model:** Giraffe OmniBed

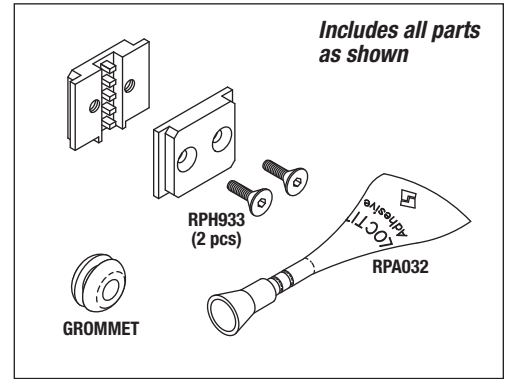

Includes all parts as shown

**RPI Part #OMB030**  
**OEM Part #6600-1372-500 (Lift Belt only), 6600-1071-400 (Belt Tensioner Spring only), 6600-1151-400 (Screw, M3 x 10 only) & 6600-1187-400 (Grommet only)**

**LIFT BELT**

- Length: 75"; Pitch: 0.1475"; Width: 0.23"
- Material: Molded polyurethane with twin stainless steel cores
- Includes: Belt Tensioner Spring (RPI Part #OMS031), (2 pcs) Screw (M3 x 10mm) (RPI Part #RPH933), Grommet, and (1 Tube) Threadlocker 242 (RPI Part #RPA032)
- Also available: Belt Block Kit (RPI Part #OMK060), Arrow Clip (RPI Part #RPC902), and Buoyancy Spring Kit (Right) (RPI Part #OMK057)

**Fits:** Lift Rail Belt Channel (Right)

**Model:** Giraffe OmniBed

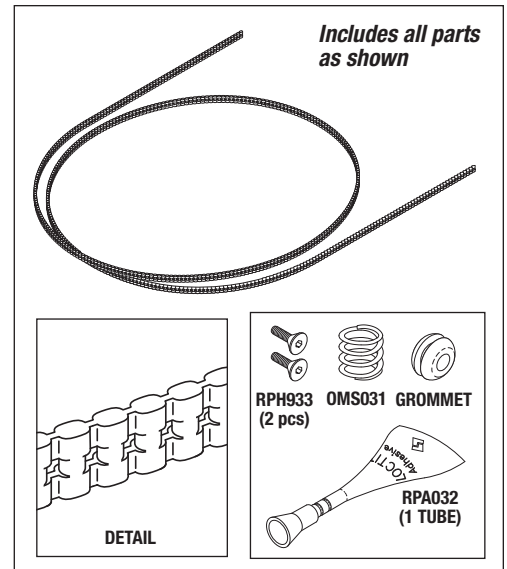

Includes all parts as shown

## New Parts to fit GE • Ohmeda Phototherapy Lights!

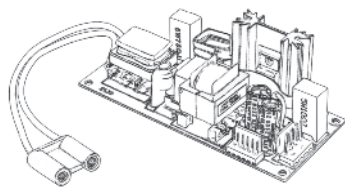

**RPI Part #OMB061**  
**OEM Part #6600-0248-850**

**BALLAST (50W REGULATED)**

- 50 VDC, 50 W
- Used with 50W Solarc™ lamp only
- Also available: Lamp (52V, 50W) (RPI Part #LMP029)

**Fits:** Chassis

**Model:** Giraffe Spot PT Lite

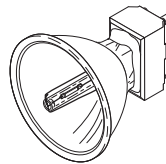

**RPI Part #LMP029**  
**OEM Part #6600-0235-850**

**LAMP (52VDC, 50W)**

- Metal Halide Solarc™ brand
- 2 Pin
- Also available: Ballast (50W regulated) (RPI Part #OMB061)

**Fits:** Lamp Ballast

**Model:** Giraffe Spot PT Lite

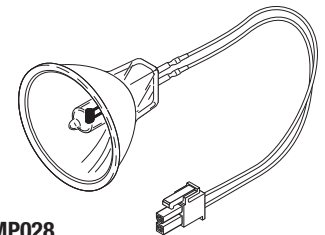

**RPI Part #LMP028**  
**OEM Part #6600-0680-200**

**LAMP (12VDC, 100W)**

- 6 per package
- Includes: Attached wire harness and connector
- Halogen

**Fits:** Lamp holder

**Models:** Biliblanket Plus & Biliblanket Plus High Output

**rpi** List of RPI Parts to fit Giraffe® Infant Incubators and OmniBed®

as of September 2015

RPI Part #	OEM Part #	Description	fits Giraffe® Incubator	fits Giraffe® OmniBed®
LMP027	6600-0912-200	Lamp	•	•
OMB030	6600-1372-500 (Lift Belt), 6600-1071-400 (Belt Tension Spring), 6600-1151-400 (Screw), 6600-1187-400 (Grommet)	Lift Belt		•
OMB035	6600-0562-603	Circuit Breaker (3.5A)	•	•
<b>OMB056</b>	6600-0215-850	LED PC Board	•	•
<b>OMC049</b>	6600-1176-400	Gearbox Coupler		•
<b>OMD051</b>	6600-1238-500	Porthole Door	•	•
OMF015	6600-0207-850	Micro Filter - 10/pkg	•	•
OMF024	6600-1523-700	Cooling Fan	•	•
<b>OMF043</b>	6600-1433-500	Fan Blade	•	•
OMG017	6600-1248-500	Corner Grommet	•	•
OMH005	6600-0220-850	Heating Assembly	•	•
OMH032	6600-0718-700, 6600-1187-400 (Grommet)	Hood Harness		•
<b>OMH044</b>	6600-1440-500	Fan Hub	•	•
OMK027	6600-0738-700	Porthole Latch Assembly Kit	•	•
OMK028	6600-1406-500 (Inside Latch Cover), 6600-1403-500 (Side Wall Latch), 6600-1405-500 (Latch Spring), 6600-1404-500 (Latch Cover)	Side Wall Latch Kit	•	•
OMK029	6600-1239-500 (Hinge Bottom), 6600-1242-500 (Hinge Cover), 6600-1240-500 (Middle Hinge), 6600-1041-400 (Hinge Pin), 6600-1040-400 (Left Spring), 6600-1026-400 (Right Spring)	Porthole Hinge Kit	•	•
OMK040	6600-0048-850	Calibration Kit	•	•
<b>OMK046</b>	6600-1738-500 (Fan Blade), 6600-1440-500 (Hub)	Fan and Hub Kit	•	•
<b>OMK050</b>	6600-1099-400 (Isolator), 6600-0712-403 (Flat Washer), 6600-0713-403 (Lock Washer), 6600-0707-407 (Screw)	Lift Motor Isolator Kit		•
<b>OMK053</b>	6600-1149-500 (Side Wall Hinge), 6600-1436-500 (Wall Hinge Snap), 6600-1429-500 (Wall Hinge Post)	Side Wall Hinge Kit	•	•
<b>OMK054</b>	6600-1436-500 (Wall Hinge Snap), 6600-1429-500 (Wall Hinge Post)	Wall Hinge Snap & Post Kit	•	•
<b>OMK057</b>	6600-1708-500 (Delrin Washer), 6600-1464-500 (Upper Buoyancy Spring), 6600-1465-500 (Lower Buoyancy Spring), 6600-1317-500 (Spring Spool), 6600-1187-400 (Grommet), 6600-0714-401 (Lock Nut)	Buoyancy Spring Kit (Right)		•
<b>OMK058</b>	6600-1708-500 (Delrin Washer), 6600-1464-500 (Upper Buoyancy Spring), 6600-1465-500 (Lower Buoyancy Spring), 6600-1725-500 (Left Buoyancy Spring), 6600-1103-400 (Spacer), 6600-1151-400 (Screw), 6600-1317-500 (Spring Spool)	Buoyancy Spring Kit (Left)		•
<b>OMK060</b>	6600-1357-500 (Belt Adjuster, Bottom), 6600-1358-500 (Block Adjuster, Top), 6600-1151-400 (Screw), 6600-1187-400 (Grommet)	Belt Block Kit		•
<b>OMM047</b>	6600-1000-400	Motor Mount - 4 per package	•	•
OMP009	6600-0873-700	Skin Temperature Probe (Disposable) - 10/pkg	•	•
OMP010	6600-0874-700	Skin Temperature Probe (Disposable) - 50/pkg	•	•
OMP011	6600-0875-700	Skin Temperature Probe (Reusable)	•	•
OMP018	6600-1512-700	Compartment Air Probe	•	•
OMP021	6600-1007-700	Touch Panel Assembly		•
OMP022	6600-1254-600	Touch Panel Assembly	•	
OMP036	6600-1473-500 (Break Plate), 6600-0706-406 (Screw)	Break Plate	•	•
OMP037	6600-1474-500	Back Plate	•	•
<b>OMP059</b>	6600-1365-500	Plate	•	•
OMR033	6600-1003-600	Solid State Relay	•	•
OMS019	6600-0820-700 (Sensor), 6600-0709-405 (Screw)	Air Flow Sensor	•	•
OMS023	6600-1154-600 (Switch), 6600-1165-400 (Locking Nut)	Door Switch		•
OMS025	6600-0736-701	Canopy Lift Switch (Left)		•
OMS026	6600-0736-702	Canopy Lift Switch (Right)		•
OMS031	6600-1071-400	Belt Tensioner Spring		•
OMS034	6600-1014-602	Power Switch/Circuit Breaker	•	•
OMS038	6600-0784-700 (Sensor), 6600-0540-400 (O-ring), 6600-1475-500 (Retainer)	Humidity Sensor	•	•
OMS039	6600-0718-700 (Complete Hood Harness), 6600-1187-400 (Grommet)	Microswitch		•
<b>OMS045</b>	6600-1557-500	Fan Seal	•	•
<b>OMS052</b>	6600-1249-500	Porthole Seal	•	•
RPA032	(No OEM Part # Available)	Threadlocker 242 - 5/pkg		•
RPC464	(No OEM Part # Available)	Heat Sink Compound - 5/pkg	•	•
RPC619	0203-1980-300	Reflective Probe Cover - 100/pkg	•	•
<b>RPC902</b>	6600-1056-400	Arrow Clip - 6/pkg		•
<b>RPH903</b>	6600-0714-401	Locknut (M3 - Nylok®) - 10/pkg	•	•
<b>RPH933</b>	6600-1151-400	Screw (M3 x 10mm S/S Flat Hd. Allen) - 25/pkg	•	•
<b>RPL901</b>	0616-0203-300 (10 oz. Tube)	Lubriplate® (130AA)	•	•

Note: New Parts are Listed In Bold Face Type.