

New Parts to fit **Dentsply Cavitron® Ultrasonic Scalers!**

DENTAL ULTRASONIC SCALERS - DENTSPLY

AIR LINES & AIR FILTERS

RPI Part #DSA002
OEM Part #60367

DUCKBILL FILTER ASSEMBLY

- Includes all parts as shown
- Clear plastic housing with 1/16" barbs, Hex body design for easy replacement of internal parts

Fits: Powder Chamber
Models: See Chart on page 6

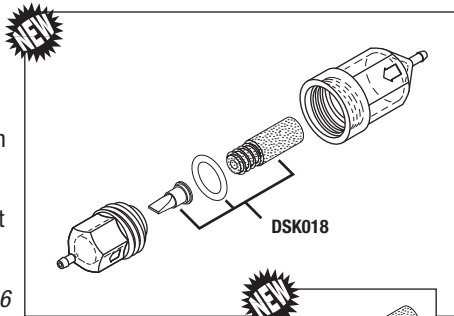

Just need the Repair Kit?

RPI Part #DSK018
OEM Part #60367

REPAIR KIT (DUCKBILL FILTER ASSEMBLY)



RPI Part #DSA008
OEM Part #63856

HOSE ASSEMBLY & FILTER (AIR)

- Includes all parts as shown
- Fits:** Cavitron to Air Source
Models: See Chart on page 6

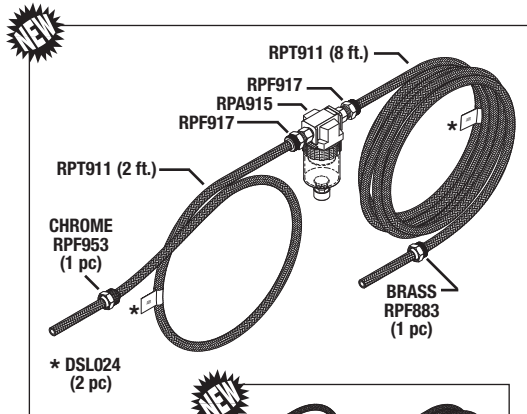

Just need the Air Hoses with PolyFlo Nuts and Labels?

RPI Part #DSH009
OEM Part #80786

AIR HOSE (BRAIDED GRAY)

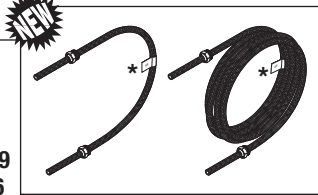

RPI Part #RPA915
OEM Part #90088

AIR FILTER ASSEMBLY

- Ports: #10-32 (M5 x 0.8)
 - Manual drain
 - Includes all parts as shown
- Fits:** Air Source to Cavitron / 1/4" Polyflo Air Hose
Models: See Chart on page 6

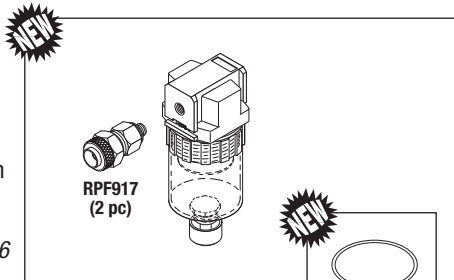

Just need the Filter Element?

RPI Part #RPE916
OEM Part # (No OEM Part # Available)

FILTER ELEMENT

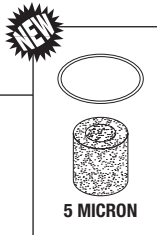

WATER LINES & WATER FILTERS

RPI Part #DSK001
OEM Part #90172

RETROFIT WATER FILTER KIT

- Includes all parts as shown
- Fits:** Water Hose
Models: See Chart on page 6

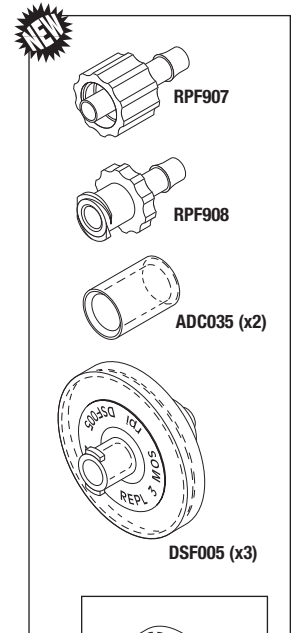

Just need the Disc Filter?

RPI Part #DSF005
OEM Part #90158

DISC FILTER (WATER)

- 10 per package

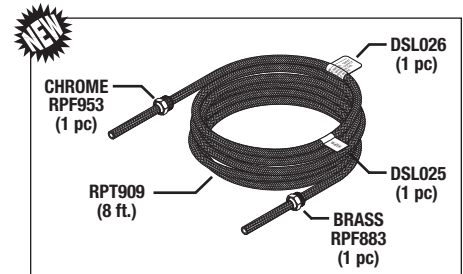

RPI Part #DSH003
OEM Part #60388

WATER HOSE (BRAIDED BLUE)

- Includes all parts as shown
- Fits:** Cavitron to Water Source
Models: See Chart on page 6

IN-LINE FILTERS & BRAIDED TUBING

- For Air & Water In-line Filters, see page 2.
- For Labels and Braided Tubing sold by the foot or box of 100 feet, see page 5.



replacement parts industries, inc.

CALL (800) 221-9723 • FAX (818) 882-7028 • EMAIL order@riparts.com • WEBSITE www.riparts.com

The above parts are manufactured by Replacement Parts Industries, Inc. to fit Dentsply equipment. All product names used in this document are trademarks or registered trademarks of their respective holders. Show 11/15

AIR & WATER IN-LINE FILTERS

SERVICE TIP

RPI's Air/Water In-Line Filters can be used to filter air and water lines including the air/water syringe on any Dental Delivery System or Unit. The clear plastic body makes it easy to detect oil and debris in the lines so you never have to guess when it is time to replace the filter. Plus, with RPI Air/Water In-Line Filter assemblies, only the filter element needs replacement, not the entire assembly - It's the RPI Advantage!

RPI Part #RPF945
OEM Part #

(No OEM Part # Available)

AIR/WATER IN-LINE FILTER (1/16" BARB)

- Includes all parts as shown
- Clear plastic housing with Hex body design for easy replacement of internal parts

Fits: 1/16" ID Tubing

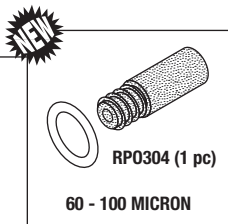
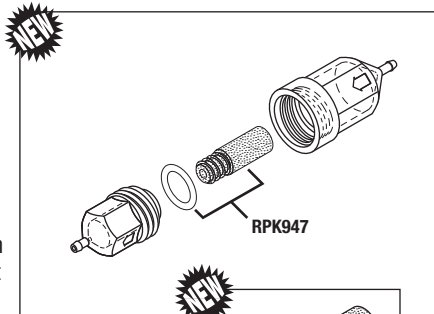

RPI Part #RPK947
OEM Part # *(No OEM Part # Available)*

IN-LINE FILTER REPLACEMENT KIT

Just need the Repair Kit?

RPI Part #RPF946
OEM Part #

(No OEM Part # Available)

AIR/WATER IN-LINE FILTER (1/8" BARB)

- Includes all parts as shown
- Clear plastic housing with Hex body design for easy replacement of internal parts

Fits: 1/8" ID Tubing

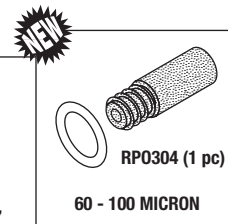
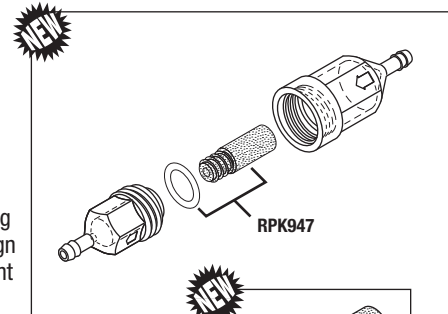

RPI Part #RPK947
OEM Part # *(No OEM Part # Available)*

IN-LINE FILTER REPLACEMENT KIT

Just need the Repair Kit?

CHECK VALVE KIT

RPI Part #DSK022
OEM Part #81167

CHECK VALVE KIT

- Includes all parts as shown
- All parts also sold separately
- This is an upgrade kit for units without check valves or with dual metallic check valves installed

Fits: Mounting Plate Assembly

Models: See Chart on page 6

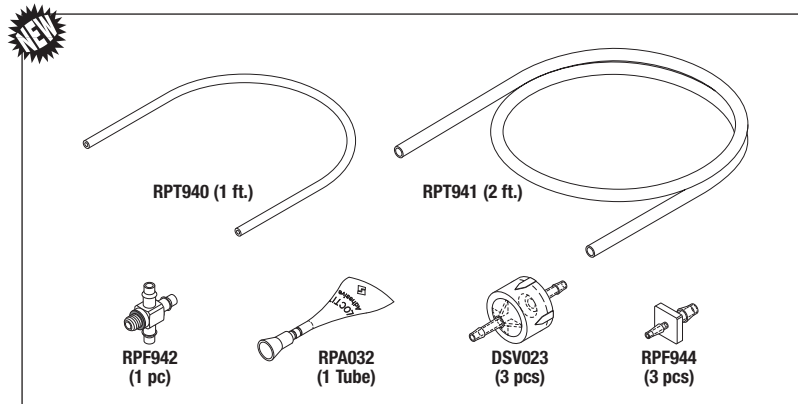

RPI Part #DSV023
OEM Part #629211001

CHECK VALVE

- 3 per package
- Size: .67" OD x .46" lg. body with 1/8" hose barbs
- Material: Clear plastic body, silicone diaphragm
- Temperature: 180°F max; Pressure: 50 PSI max

Fits: Mounting Plate Assembly

Models: See Chart on page 6

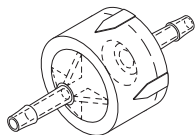

RPI Part #RPF942
OEM Part #623064002

CROSS FITTING (1/8" BARB x #10-32 MALE)

- 5 per package
- Material: Nickel plated brass
- Includes: Sealing washer

Fits: Quick Connect to Bottle "A"
Models: See Chart on page 6

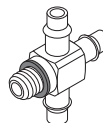

RPI Part #RPF944
OEM Part #621068001

ADAPTOR FITTING (1/16" BARB x 1/8" BARB)

- 10 per package
- Material: Clear polypropylene

Fits: 1/16" ID x 1/8" ID Tubing
Models: See Chart on page 6

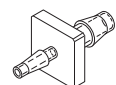

WATER SOLENOID VALVES



RPI Part #DSV006
OEM Part #571070003

SOLENOID VALVE (WATER)

- Ports: 1/8" FPT; 2 way; N.C.
- 24VDC, 60Hz., 3.0 W; 6" lg. wires with 2 pin connector
- Material: Stainless steel body; Viton seals
- Includes all parts as shown

Fits: Water Chassis

Models: See Chart on page 6

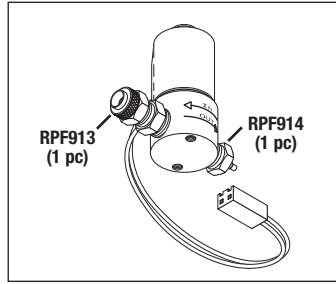

RPI Part #DSV019
OEM Part #81258

SOLENOID VALVE (WATER)

- Ports: 1/8" FPT; 2 way; N.C.
- 24VAC, 50-60Hz., 6.0 W; 6" lg. wires with 2 pin connector
- Material: Brass body; Buna N seals
- Includes all parts as shown

Fits: Transformer Mount and Lavage Assembly

Models: See Chart on page 6

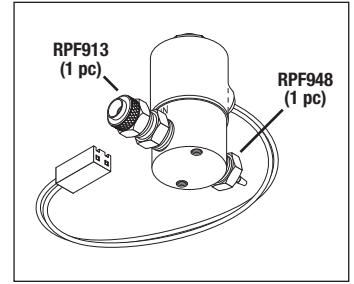

RPI Part #DSV015
OEM Part #571070002

SOLENOID VALVE (WATER)

- Ports: 1/8" FPT; 2 way; N.C.
- 24VDC, 60Hz., 3.0 W; 6" lg. wires with 2 pin connector
- Material: Stainless steel body; Viton seals
- Includes all parts as shown

Fits: Water Chassis

Models: See Chart on page 6

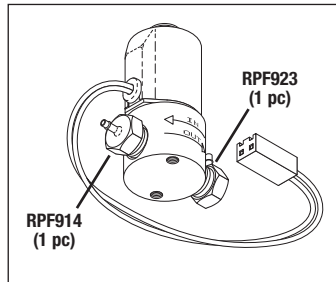

RPI Part #DSK020
OEM Part # (No OEM Part # Available)

SOLENOID VALVE REPAIR KIT

- Includes: Plunger with spring, O-ring and bonnet

Fits: Solenoid Valve (Water)

Models: See Chart on page 6

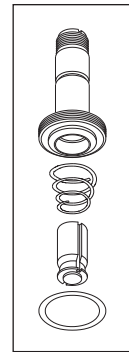

RPI Part #DSK016
OEM Part # (No OEM Part # Available)

SOLENOID VALVE REPAIR KIT

- Includes: Plunger with spring and O-ring

Fits: Solenoid Valve (Water)

Models: See Chart on page 6

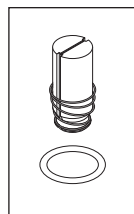

RPI Part #DSC017
OEM Part # (No OEM Part # Available)

COIL (SOLENOID VALVE)

- 24VDC, 3.0 W, 488Ω, 6" lg. wires with 2 pin connector

Fits: Solenoid Valve (Water)

Models: See Chart on page 6

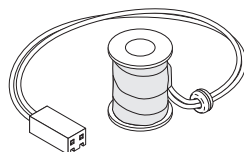

O-RINGS



RPI Part #RP0924
OEM Part #62605

O-RING (GREEN)

- 12 per package
- Size: .145" ID x .285" OD x .070" C/S
- Material: Viton, Duro: 75

Fits: Insert Stack Groove; for Insert Types: Classic P, SLI, PEC, Jet Air Polishing Insert, Cavitron MED

Models: See Chart on page 6



Shown
Actual Size

RPI Part #RP0342
OEM Part #62351

O-RING (BLACK)

- 12 per package
- Size: .145" ID x .285" OD x .070" C/S
- Material: Viton, Duro: 70

Fits: Insert Stack Groove; for Insert Types: TFI, FSI, FSI-SLI, Bellissima, Cavitron

THINinsert (Dental Ultrasonic Scalers)

Models: See Chart on page 6



Shown
Actual Size

FITTINGS & ADAPTORS

RPI Part #RPF913
OEM Part # (No OEM Part # Available)

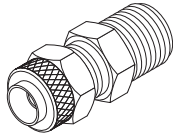

POLYFLO FITTING
(1/4" TUBE x 1/8" MPT)

- 5 per package
 - Material: Brass body with plastic sleeve/ferrule
 - Also available: Polyflo Nut (RPI Part #RPF883)
- Fits:** 1/4" OD Plastic Tubing x 1/8" FPT Ports
Models: See Chart on page 6

RPI Part #RPF917
OEM Part # (No OEM Part # Available)

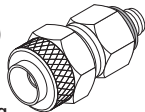

POLYFLO FITTING (1/4" TUBE x #10-32 MALE)

- 5 per package
 - Material: Brass with rubber sealing washer
 - For use with most plastic and soft metal tubing
 - Included in: Air Filter Assembly (RPI Part #RPA915)
- Fits:** Air Filter Assembly
Models: See Chart on page 6

RPI Part #RPF953
OEM Part # (No OEM Part # Available)



POLYFLO NUT (1/4" CHROME)

- 5 per package
 - Material: Chrome plated brass
 - Included in: Water Hose (Braided Blue) (RPI Part #DSH003) and Air Hose (Braided Gray) (RPI Part #DSH009)
- Fits:** Quick Connect to Air or Water Line
Models: See Chart on page 6

RPI Part #RPF883
OEM Part # (No OEM Part # Available)

BRASS



POLYFLO NUT (1/4" BRASS)

- 5 per package
 - Fits: 1/4" OD plastic tube
 - Material: Brass
 - Included in: Water Hose (Braided Blue) (RPI Part #DSH003) and Air Hose (Braided Gray) (RPI Part #DSH009)
- Fits:** Water and Air Hoses
Models: See Chart on page 6

RPI Part #ADS032
OEM Part # (No OEM Part # Available)



POLYFLO SLEEVE/FERRULE (1/4")

- 25 per package
- Fits:** 1/4" OD Tubing with 1/8" Barb
Models: See Chart on page 6

RPI Part #ADC058
OEM Part # (No OEM Part # Available)



CORD CLIP

- 10 per package
 - 3/8" bundle size
 - Natural Nylon with adhesive backing
 - Meets UL94V-2 Flame Class
- Models:** See Chart on page 6

RPI Part #RPF948
OEM Part # (No OEM Part # Available)



LOOK! This Adaptor has a unique orifice that allows for the precise control of the solenoid valve output.

ADAPTOR (1/16" BARB x 1/8" MPT)

- 5 per package
 - Material: Nickel plated brass
 - See the special **LOOK!** note
 - Included in: Solenoid Valve (Water) (RPI Part #DSV019)
- Fits:** 1/16" ID Plastic Tubing x 1/8" FPT Ports
Models: See Chart on page 6

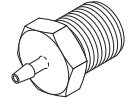

RPI Part #RPF914
OEM Part # (No OEM Part # Available)

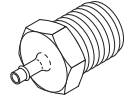

ADAPTOR (1/16" BARB x 1/8" MPT)

- 5 per package
 - Material: Brass
 - Included in: Solenoid Valve (Water) (RPI Part #'s DSV006 & DSV015)
- Fits:** 1/16" ID Plastic Tubing x 1/8" FPT Ports
Models: See Chart on page 6

RPI Part #RPF923
OEM Part #63827

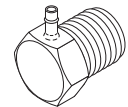

ADAPTOR ELBOW (1/16" BARB x 1/8" MPT)

- 5 per package
 - Material: Brass
 - Included in: Solenoid Valve (Water) (RPI Part #DSV015)
- Fits:** 1/16" ID Plastic Tubing x 1/8" FPT Port
Models: See Chart on page 6

UNI-CLAMP & SLEEVE CLAMP

RPI Part #ADC035
OEM Part # (No OEM Part # Available)

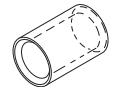

SLEEVE CLAMP

- 20 per package; Material: Plastic
- Fits:** 1/4" OD Tubing with 1/8" Barb
Models: See Chart on page 6

RPI Part #ADC034
OEM Part # (No OEM Part # Available)

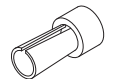

UNI-CLAMP

- 20 per package; Material: Plastic
- Fits:** 1/8" OD Tubing with 1/16" Barb
Models: See Chart on page 6

RPI Part #RPT296
OEM Part # (No OEM Part # Available)

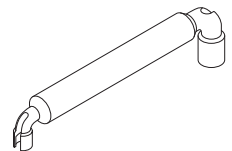

UNIVERSAL SLEEVE TOOL

- ~5" lg.
 - Used on 1/4" OD and 1/8" OD tubing
 - Used to install 1/4" Sleeve Clamps and Uni-Clamp (RPI Part #ADC035) and 1/8" Uni-Clamp (RPI Part #ADC034)
 - The tool provides 90° angles on both ends for ease of use
- Models:** See Chart on page 6

POLYURETHANE TUBING

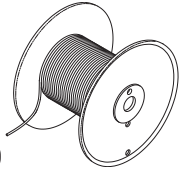

RPI Part #RPT940
OEM Part #61963

TUBING (1/16" ID x 1/8" OD
CLEAR POLYURETHANE)

- Sold by the foot (reel not included)
- Fits: 1/16" Barb
- Models: See Chart on page 6

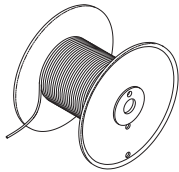

RPI Part #RPT911
OEM Part #625075001

TUBING (.107" ID x 3/16" OD
BLUE POLYURETHANE)

- Sold by the foot (reel not included)
- Fits: 1/8" Barb or 3/16" Push-in Fitting
- Models: See Chart on page 6

BRAIDED TUBING & IDENTIFYING LABELS

- Available by the foot or in a box of 100 ft.
- Size: .150" ID x .250" OD PVC tubing with blue or gray over braided sleeve
- Fits: 1/4" Polyflo or 5/32" Barb
- Models: See Chart on page 6

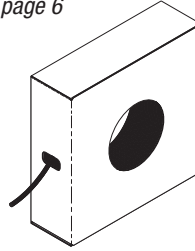

Just Ask For:



RPI Part #RPT909
BRAIDED TUBING (1/4" OD BLUE)
Sold by the Foot



RPI Part #RPT910
BRAIDED TUBING (1/4" OD BLUE)
Box of 100 ft.



RPI Part #RPT911
BRAIDED TUBING (1/4" OD GRAY)
Sold by the Foot



RPI Part #RPT912
BRAIDED TUBING (1/4" OD GRAY)
Box of 100 ft.



AIR

AIR

RPI Part #DSL024
OEM Part # (No OEM Part # Available)

LABEL (AIR)
• 3 per package

Use with
Braided Tubing



WATER

WATER

RPI Part #DSL025
OEM Part # (No OEM Part # Available)

LABEL (WATER)
• 3 per package

Use with
Braided Tubing



CAUTION
ALWAYS CLOSE THE WATER SHUT
OFF VALVE IN THE WATER SUPPLY
TO THE UNIT WHENEVER THE
UNIT IS NOT IN USE.

RPI Part #DSL026
OEM Part # (No OEM Part # Available)

LABEL (CAUTION)
• 3 per package

Use with
Braided Tubing

WATER HOSE LUER LOCKS

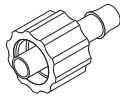

RPI Part #RPF907
OEM Part #621066001

LUER LOCK (MALE x 5/32" BARB)

- 10 per package
- Material: Clear polycarbonate
- Accommodates .150" or (4 mm) ID tubing

Fits: Water Hose

Models: See Chart on page 6

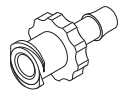

RPI Part #RPF908
OEM Part #621065001

LUER LOCK (FEMALE x 5/32" BARB)

- 10 per package
- Material: Clear polycarbonate
- Accommodates .150" or (4 mm) ID tubing

Fits: Water Hose

Models: See Chart on page 6

TRANSISTOR, FUSES & POWER CORDS

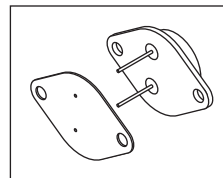

RPI Part #DST014
OEM Part #574335001, 61350

TRANSISTOR

- Includes: Darlington transistor and insulation gasket

Fits: Electrical Chassis

Models: See Chart on page 6

RPI Part #RPF922
OEM Part #60537



FUSE (630MA, 250V) 5MM x 20MM TIME DELAY

- 5 per package; Type: Glass
- For use with 220V units

Fits: PCB Fuse Holder

Models: See Chart on page 6

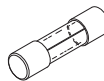

RPI Part #RPF524
OEM Part #557034018

FUSE (1/8A, 250V) 5MM x 20MM TIME DELAY

- 5 per package; Type: Glass
- For use with 120V units

Fits: Power Entry Module

Models: See Chart on page 6

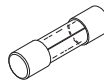

- Color: Gray
- 16/3 SJT, 60°C; 13A @ 125VAC
- Plug: NEMA 5-15P
- Connector: EN60320-C13

Fits: Power Input Module

Models: See Chart on page 6

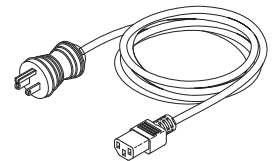

RPI Part #RPC557
OEM Part #554102003

HOSPITAL GRADE POWER CORD
(13A @ 125VAC, 8 ft.)

- Length: 8 ft.

Standard
8 ft. Long
Cord!

RPI Part #RPC869
OEM Part # (No OEM Part # Available)

HOSPITAL GRADE POWER CORD
(13A @ 125VAC, 3 ft.)

- Length: 3 ft.

Convenient
3 ft. Long
Cord!

RPI Part #RPC868
OEM Part # (No OEM Part # Available)

HOSPITAL GRADE POWER CORD
(13A @ 125VAC, 1.5 ft.)

- Length: 1.5 ft.

Handy
1.5 ft. Long
Cord!



replacement parts industries, inc.

20338 Corisco Street • Chatsworth, California • 91311

PRESORTED STANDARD
U.S. POSTAGE PAID
VAN NUYS, CA
PERMIT NO. 2399

ADDRESS SERVICES REQUESTED

RPI Parts to fit _____

Dentsply Cavitron® Ultrasonic Scalers!

| RPI Part # | OEM Part # | Description | BOBCAT® 25 KHz - G115 | BOBCAT® Pro - G130 | DualSelect™ System - G118 | JET Plus™ - G132 | JET with SPS™ - G120 | Plus™ Scaler - G131 | Proprietary-JET® Polishing System - G122 | Select™ Scaler 25K - G121 | Select™ SPS™ 30K - G124 | SPS™ Surface Mount Ultrasonic Scaler - G98a | SPS™ Ultrasonic Scaler - G119 |
|------------|-------------------------|----------------------------------------------------------|--------------------------|-----------------------|------------------------------|---------------------|-------------------------|------------------------|---------------------------------------------|------------------------------|----------------------------|---------------------------------------------------|-------------------------------------|
| ADC034 | No OEM Part # Available | Uni-Clamp - 20/pkg | • | • | • | • | • | • | • | • | • | • | • |
| ADC035 | No OEM Part # Available | Sleeve Clamp - 20/pkg | • | • | • | • | • | • | • | • | • | • | • |
| ADC058 | No OEM Part # Available | Cord Clip - 10/pkg | • | • | • | • | • | • | • | • | • | • | • |
| ADS032 | No OEM Part # Available | Polyflo Sleeve/Ferrule (1/4") - 25/pkg | • | • | • | • | • | • | • | • | • | • | • |
| DSA002 | 60367 | Duckbill Filter Assembly | | | • | | | | | | | | |
| DSA008 | 63856 | Hose Assembly & Filter (Air) | | • | | | | | | | | | |
| DSC017 | No OEM Part # Available | Coil (Solenoid Valve) | | | | • | | | | | | | • |
| DSF005 | 90158 | Disc Filter (Water) - 10/pkg | • | • | • | • | • | • | • | • | • | • | • |
| DSH003 | 60388 | Water Hose (Braided Blue) | • | • | • | • | • | • | • | • | • | • | • |
| DSH009 | 80786 | Air Hose (Braided Gray) | | • | | | | | | | | | |
| DSK001 | 90172 | Retrofit Water Filter Kit | • | • | • | • | • | • | • | • | • | • | • |
| DSK016 | No OEM Part # Available | Solenoid Valve Repair Kit | | | | | | | | | | | • |
| DSK018 | 60367 (complete Assy.) | Repair Kit (Duckbill Filter Assembly) | | | • | | | | | | | | |
| DSK020 | No OEM Part # Available | Solenoid Valve Repair Kit | | • | | | | | | | | | |
| DSK022 | 81167 | Check Valve Kit | | • | | | | | | | | | |
| DSL024 | No OEM Part # Available | Label (Air) - 3/pkg | | | | • | | | | | | | |
| DSL025 | No OEM Part # Available | Label (Water) - 3/pkg | • | • | • | • | • | • | • | • | • | • | • |
| DSL026 | No OEM Part # Available | Label (Caution) - 3/pkg | • | • | • | • | • | • | • | • | • | • | • |
| DST014 | 574335001, 61350 | Transistor | • | • | • | • | • | • | • | • | • | • | • |
| DSV006 | 571070003 | Solenoid Valve (Water) | | | | | • | | | | | | • |
| DSV015 | 571070002 | Solenoid Valve (Water) | | | | | | | • | | | | |
| DSV019 | 81258 | Solenoid Valve (Water) | | • | | | | | | | | | |
| DSV023 | 629211001 | Check Valve | | • | | | | | | | | | |
| RPA915 | 90088 | Air Filter Assembly | | • | • | • | • | • | • | • | • | • | • |
| RPC557 | 554102003 | Hospital Grade Power Cord (13A @ 125VAC, 8 ft.) | • | • | • | • | • | • | • | • | • | • | • |
| RPC868 | 554102003 | Hospital Grade Power Cord (13A @ 125VAC, 1.5 ft.) | • | • | • | • | • | • | • | • | • | • | • |
| RPC869 | 554102003 | Hospital Grade Power Cord (13A @ 125VAC, 3 ft.) | • | • | • | • | • | • | • | • | • | • | • |
| RPE916 | No OEM Part # Available | Filter Element | | • | • | • | • | • | • | • | • | • | • |
| RPF524 | 557034018 | Fuse (1/8A, 250V) 5mm x 20mm Time Delay - 5/pkg | • | • | • | • | • | • | • | • | • | • | • |
| RPF883 | No OEM Part # Available | Polyflo Nut (1/4" Brass) - 5/pkg | • | • | • | • | • | • | • | • | • | • | • |
| RPF907 | 621066001 | Luer Lock (Male x 5/32" Barb) - 10/pkg | • | • | • | • | • | • | • | • | • | • | • |
| RPF908 | 621065001 | Luer Lock (Female x 5/32" Barb) - 10/pkg | • | • | • | • | • | • | • | • | • | • | • |
| RPF913 | No OEM Part # Available | Polyflo Fitting (1/4" Tube x 1/8" MPT) - 5/pkg | • | • | • | • | • | • | • | • | • | • | • |
| RPF914 | No OEM Part # Available | Adaptor (1/16" Barb x 1/8" MPT) - 5/pkg | • | • | • | • | • | • | • | • | • | • | • |
| RPF917 | No OEM Part # Available | Polyflo Fitting (1/4" Tube x #10-32 Male) - 5/pkg | • | • | • | • | • | • | • | • | • | • | • |
| RPF922 | 60537 | Fuse (630MA, 250V) 5mm x 20mm Time Delay - 5/pkg | • | • | • | • | • | • | • | • | • | • | • |
| RPF923 | 63827 | Adaptor Elbow (1/16" Barb X 1/8" MPT) - 5/pkg | • | • | • | • | • | • | • | • | • | • | • |
| RPF942 | 623064002 | Cross Fitting (1/8" Barb x #10-32 Male) - 5/pkg | • | • | • | • | • | • | • | • | • | • | • |
| RPF944 | 621068001 | Adaptor Fitting (1/16" Barb x 1/8" Barb) - 10/pkg | • | • | • | • | • | • | • | • | • | • | • |
| RPF948 | No OEM Part # Available | Adaptor (1/16" Barb x 1/8" MPT) - 5/pkg | • | • | • | • | • | • | • | • | • | • | • |
| RPF953 | No OEM Part # Available | Polyflo Nut (1/4" Chrome) - 5/pkg | • | • | • | • | • | • | • | • | • | • | • |
| RP0342 | 62351 | O-Ring (Black) - 12/pkg | • | • | • | • | • | • | • | • | • | • | • |
| RP0924 | 62605 | O-Ring (Green) - 12/pkg | • | • | • | • | • | • | • | • | • | • | • |
| RPT296 | No OEM Part # Available | Universal Sleeve Tool | • | • | • | • | • | • | • | • | • | • | • |
| RPT909 | No OEM Part # Available | Braided Tubing (1/4" OD Blue) - per ft. | • | • | • | • | • | • | • | • | • | • | • |
| RPT910 | No OEM Part # Available | Braided Tubing (1/4" OD Blue) (Box of 100 ft.) | • | • | • | • | • | • | • | • | • | • | • |
| RPT911 | No OEM Part # Available | Braided Tubing (1/4" OD Gray) - per ft. | • | • | • | • | • | • | • | • | • | • | • |
| RPT912 | No OEM Part # Available | Braided Tubing (1/4" OD Gray) (Box of 100 ft.) | • | • | • | • | • | • | • | • | • | • | • |
| RPT940 | 61963 | Tubing (1/16" ID x 1/8" OD Clear Polyurethane) - per ft. | • | • | • | • | • | • | • | • | • | • | • |
| RPT941 | 625075001 | Tubing (.107" ID x 3/16" OD Blue Polyurethane) - per ft. | • | • | • | • | • | • | • | • | • | • | • |

Call Us Toll-Free Monday-Friday, 8:00 AM-4:30 PM (Pacific Time), (800) 221-9723